

- No window unit.

3. LIST OF ALTERATION AND ADDITION WORKS NOT ALLOWED

1. anything that will affect the look of the external facade, eg. Painting of balcony.
2. install windows at balcony (no enclosure of the balcony);
3. removal of railing at the balcony;
4. replace glazing of window with colours that are different from original;
5. install air conditioner (window unit);
6. unauthorised modification/relocation of intercom set.
7. install trellis or permanent awnings at Penthouse's open terrace, as the permissible allowable Average Mean Sea Level (AMSL) is 64.00m.

4. GRILLE DESIGN

1. Door grille to be installed at the wooden frame or within the strata line of the unit and the full swing is not to go beyond half of the corridor width.
2. All other grille to be installed within the unit internal side and behind the window and/or sliding door.
3. Approved colour : To be determined by the Management Office.
4. Exact measurements to be verified on-site by contractor.
5. All indicative drawings are not to scale.

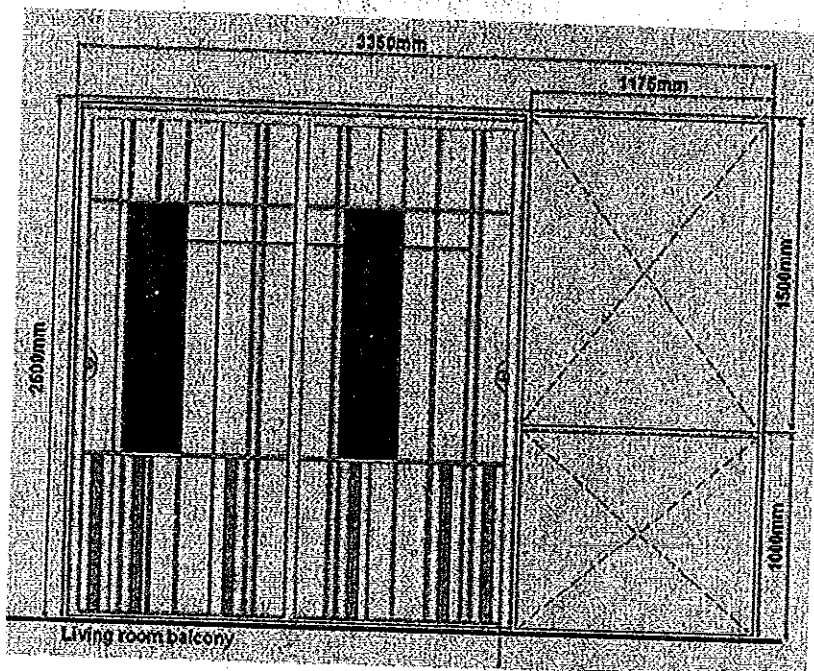
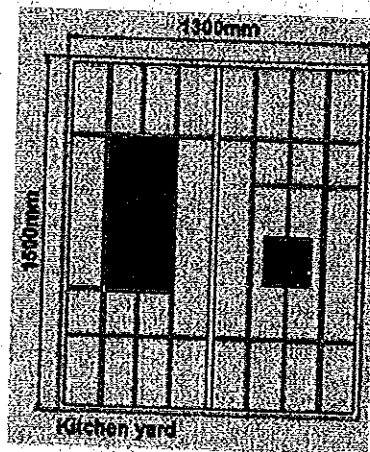
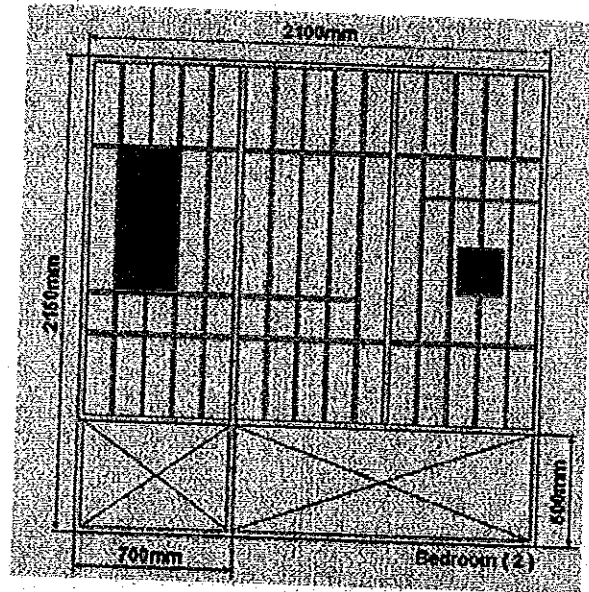

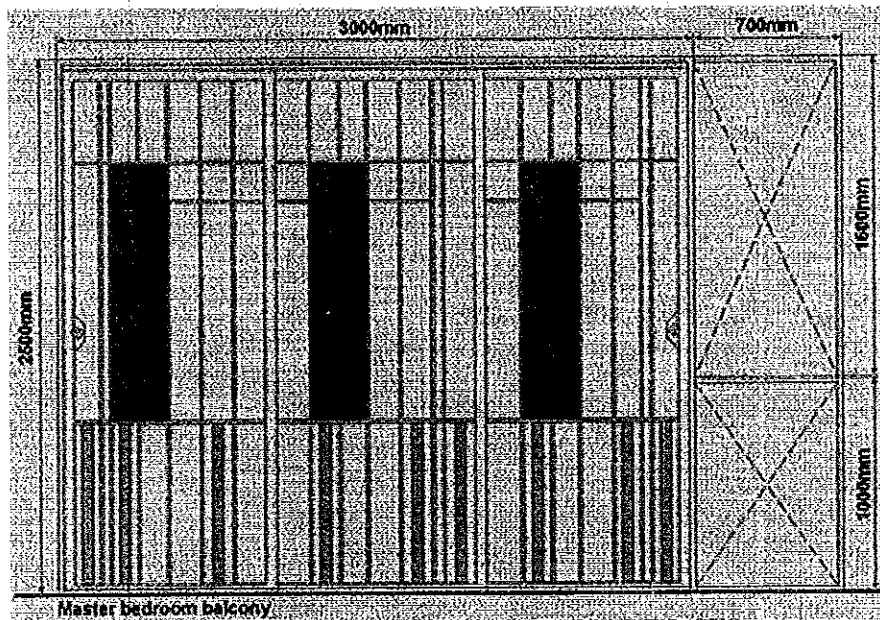
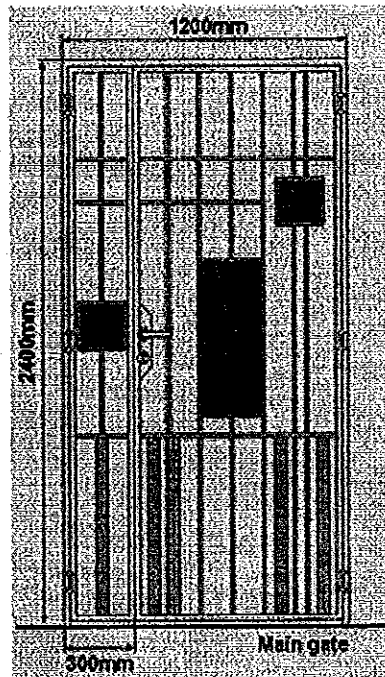

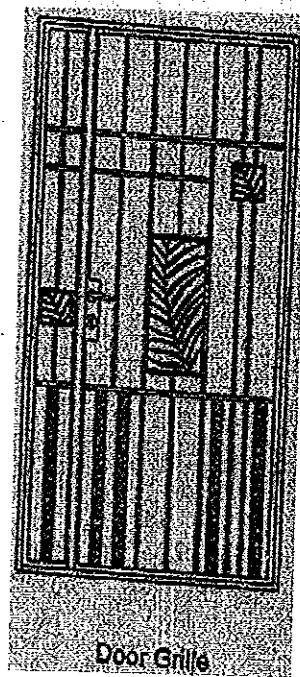
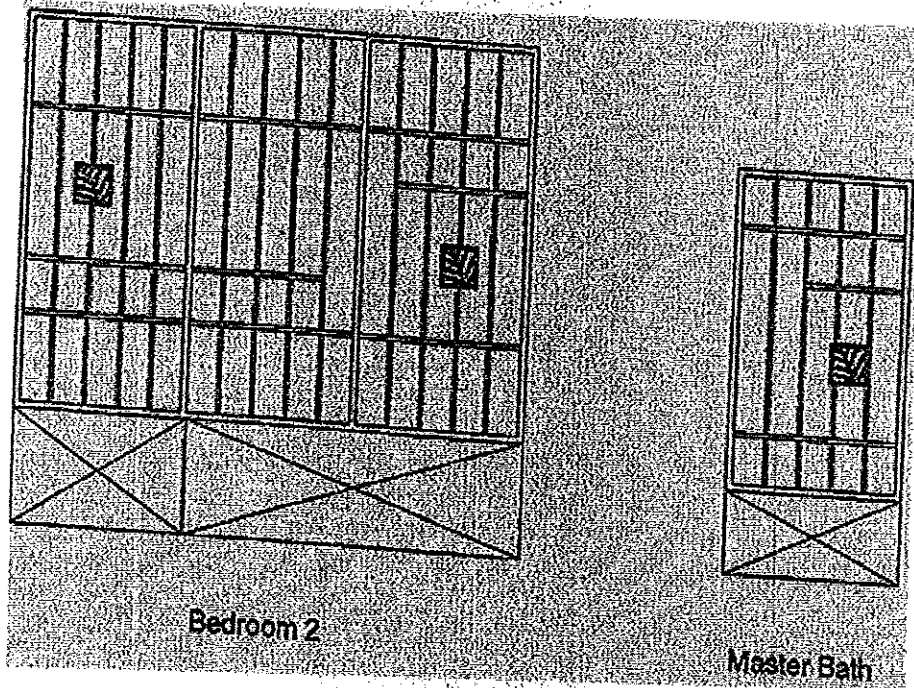

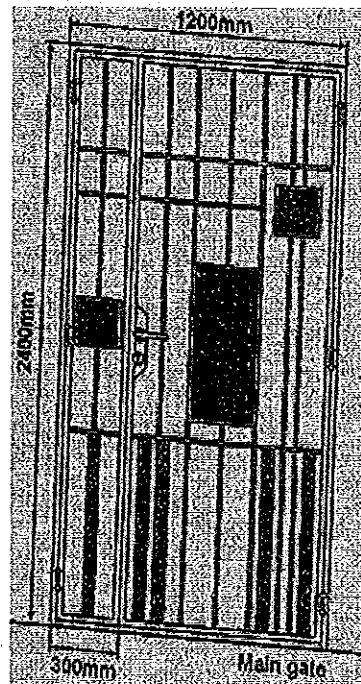
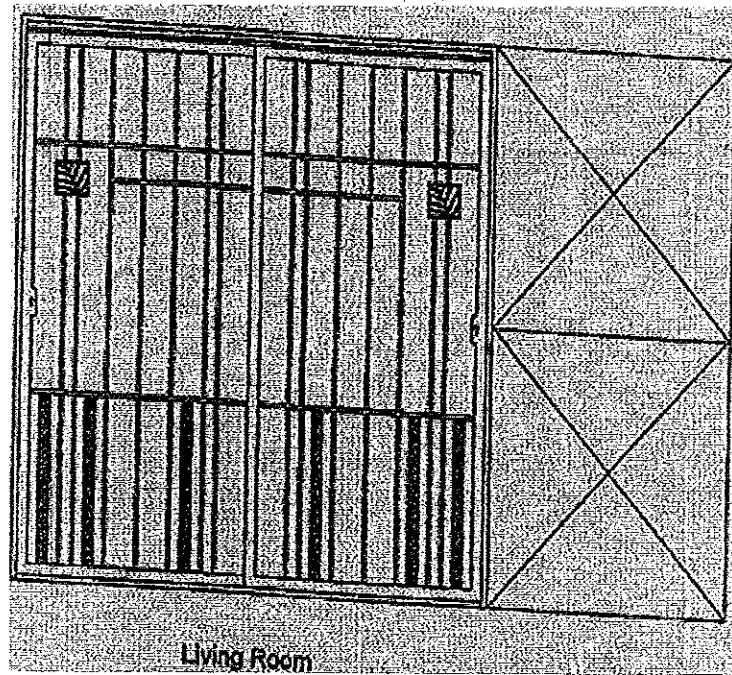

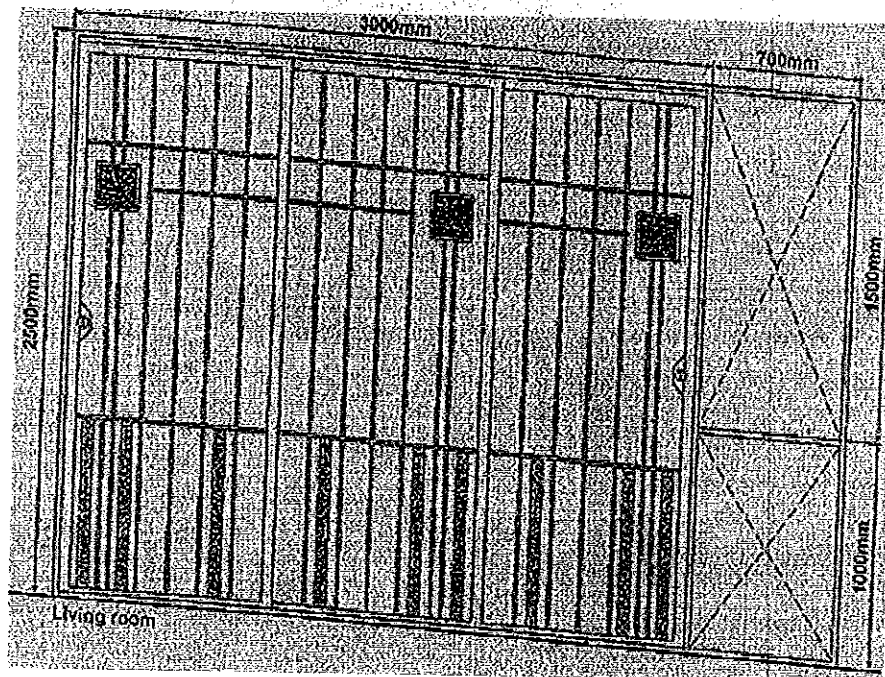
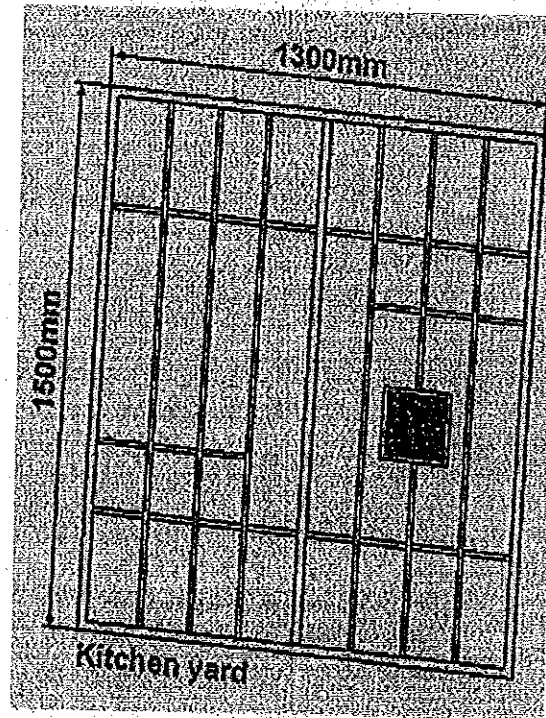

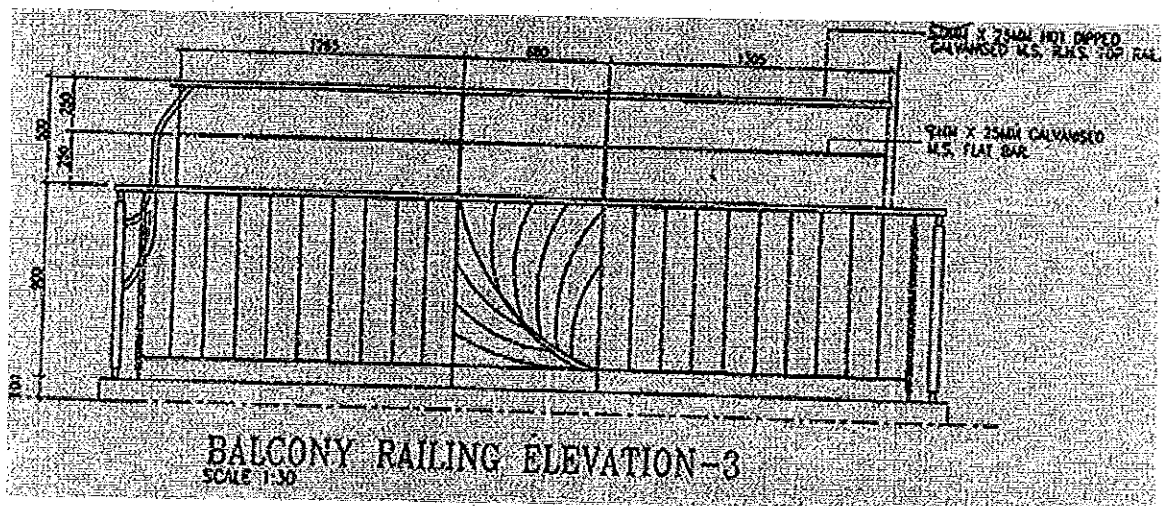
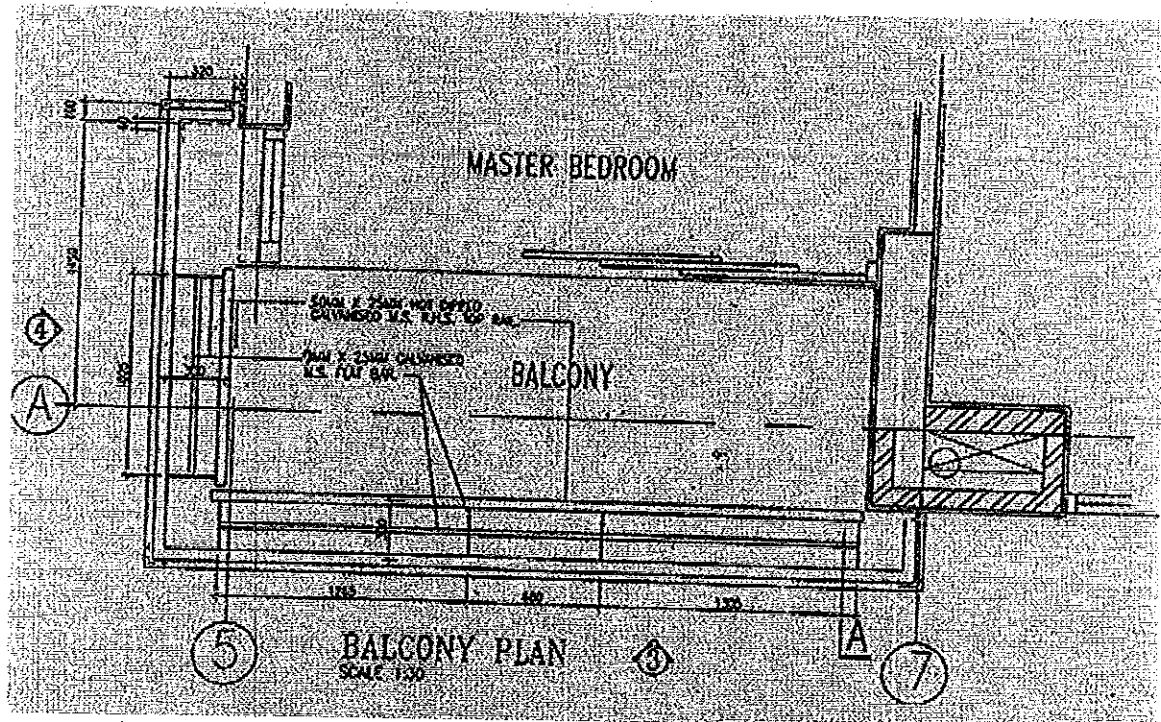

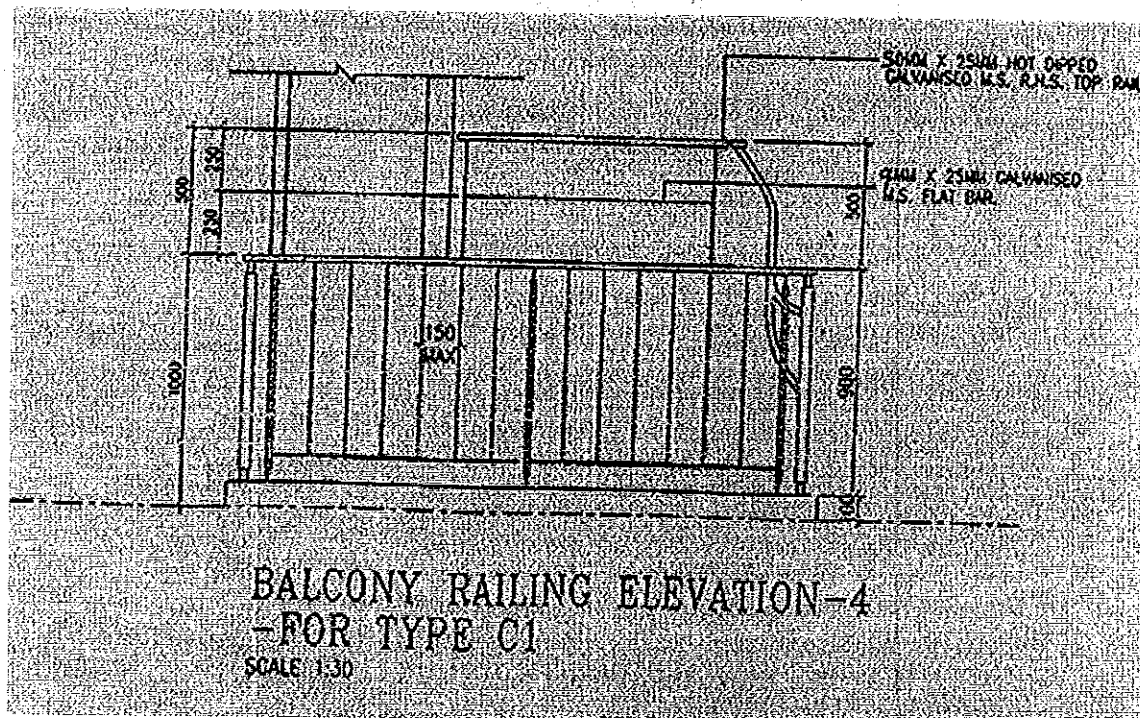

5. TERMS & CONDITIONS FOR INSTALLATION OF RETRACTABLE AWNINGS (Only units with PES)

1. Retractable Awnings

- a. Canvas Type
- b. Colour: To be determined by the Management.
- c. Full projection of the retractable awning should not exceed the strata boundary. However, should the strata boundary extended beyond 2 metres, the full projection should not exceed 2 metres. All installation works, inclusive of the retractable awning arms, must be within the strata boundary.
 - Fixed awning and any other fixed roofing structure is strictly prohibited. (As per the authorities' guidelines)

2. Authority's Approval

- a. The subsidiary proprietor is responsible to engage a qualified person to submit the proposed installations to the relevant authorities for clearance. Eg. URA, BCA, FSSB, etc.